

RFS - 40

Open Vat Fryer - 40 lbs.

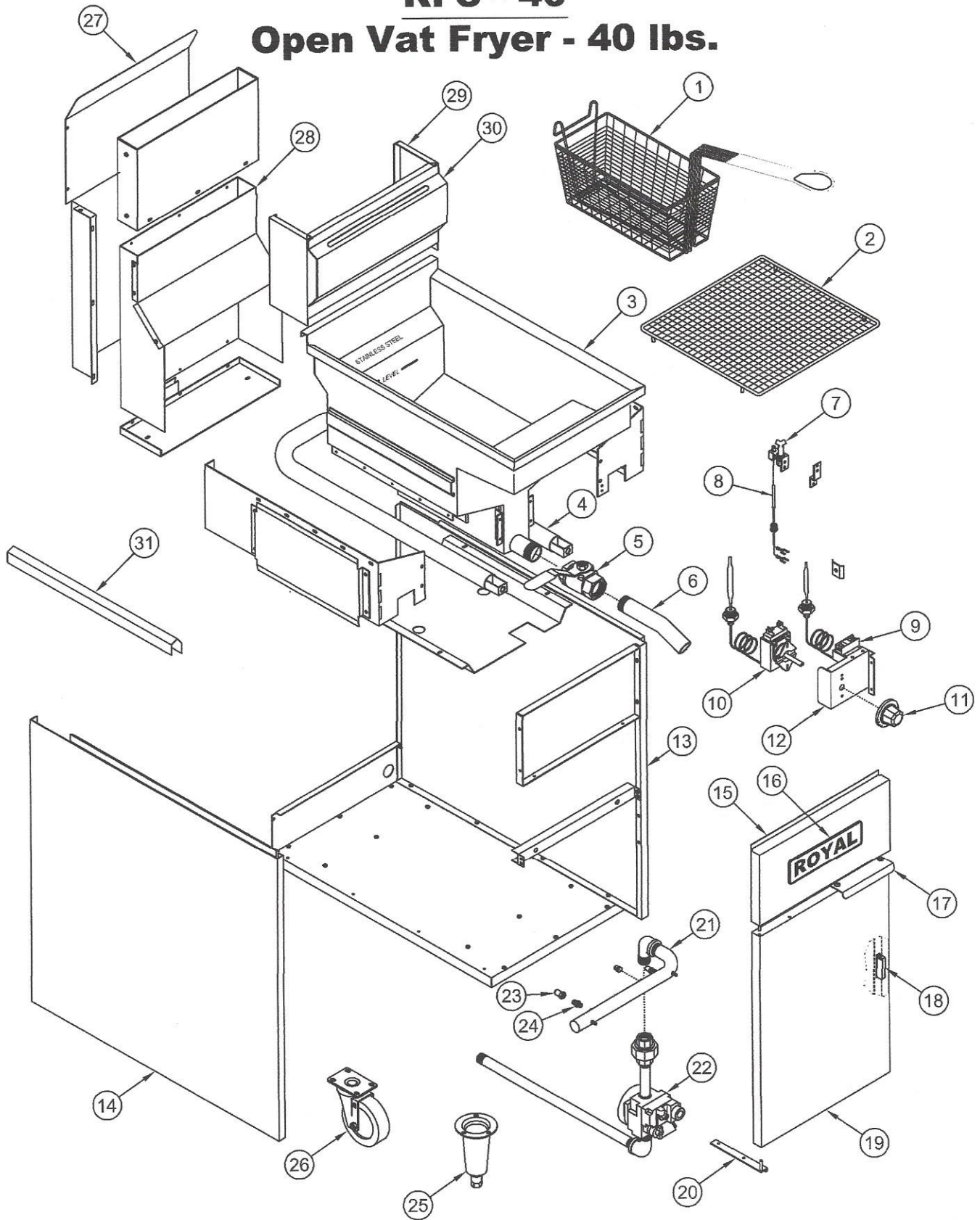

PILOT	THERMOPILE	HI LIMIT	THERMOSTAT	KNOB THERMOSTAT	ORIFICE HOOD	ORIFICE ADAPTER
(7)	(8)	(9)	(10)	(11)	(23)	(24)

RFS - 40

Open Vat Fryer – 40 lbs.

ITEM NO.	PART NO.	DESCRIPTION	
1	3100	Frying basket	
2	3101	Crumb screen (fine mesh)	
3	28051	Vessel assembly (s/st)	
4	2105	"U" Burner	
5	3133	Drain valve 1-1/4" NPT.	
6	3132	Drain extension pipe 1-1/4 NPT.	
7	2107	Pilot burner w/bell orifice (natural gas)	
	2106	Pilot burner w/bell orifice (propane gas)	
	3233	Pilot bell orifice only (natural gas)	
	3234	Pilot bell orifice only (propane gas)	
8	3109	Thermopile	
065401 080651	9	3112	Hi-limit switch
065402	10	3113	Thermostat
054304	11	3110	Knob, thermostat
063145	12	28003	Bracket – thermostat, hi limit
	13	28201	Side outer panel – Right side
	14	28202	Side outer panel – Left side
	15	28205	Front panel
	16	2649	Royal logo (Large)
	17	1005	Offset pull handle – chrome handle
	18	1724	Door magnet
130157 130160	19	28237	Door assembly
	20	28020	Door hinge assembly
	21	1727	Manifold pipe
22	3114	Gas valve 3/4" natural gas	
	3115	Gas valve 3/4" propane gas	
23	1121-32	Orifice hood # 32 (brass) natural gas, 52,500 BTU	
	1122-48	Orifice hood # 48 (brass) propane gas, 52,500 BTU	
24	1733	Orifice adapter 3/8-27 x 1/8 NPT	
25	1219	Chrome cone leg	
26	2193	Caster 5" w/brake	
	2192	Caster 5" without brake	
27	28221	Back Panel	
28	28236	Flue box assy.	
29	28220	Riser back	
30	28208	Basket hanger	
31	28238	Joiner strip	