



THE NEW SYMBOL OF INNOVATION

# Two Door Back Bar Cooler

**JBB-80** 80.25" wide, 180 (6-packs) or 3 (1/2 barrel kegs)



- **Stainless steel interior bottom standard!**
- **Door locks standard!**
- **Stainless steel countertop standard!**
- **Optional glass doors available.**

**STANDARD FEATURES:**

- Capillary tube
- CFC-free R-134a Refrigerant
- Forced Air Refrigeration
- One Interior Incandescent Light
- Adjustable Bullet Feet (if necessary)
- Foamed-in-place Polyurethane Insulation
- Thermostatic Control
- Assembled in the USA
- Side-Mounted Compressor
- 2 Epoxy Coated Shelves per door
- Door Locks

**MATERIALS:**

INTERIOR: Stainless steel interior bottom for durability and appearance.  
Galvanized powder coated steel walls.

EXTERIOR: Stainless steel countertop  
Galvanized powder coated matte black finish



This equipment is intended for the storage and display of nonpotentially hazardous, bottled or canned products only

## DIMENSIONAL DATA:

Model No.	L	D	H	Doors	Cu.Ft.	H/P	Volt	Amp.	NEMA	Shipping Wt.
JBB-58	58.0	27.0	36.4	2	15	1/5	115/60/1	5.1	5-20P	290
<b>JBB-80</b>	<b>80.25</b>	<b>27.0</b>	<b>36.4</b>	<b>3</b>	<b>21</b>	<b>1/4</b>	<b>115/60/1</b>	<b>6.1</b>	<b>5-20P</b>	<b>370</b>
JDD-58	58.0	27.0	36.4	2	15	1/5	115/60/1	5.1	5-20P	290
JDD-80	80.25	27.0	36.4	3	21	1/4	115/60/1	6.1	5-20P	370



Refrigeration Equipment Manufacturer

## Back Bar Unit

# JBB-80

Description: Three door back bar cooler, 21 cu. ft

### Features & Benefits

**Stainless steel interior bottom** for greater durability, construction and appearance.

Self-contained **side-mounted refrigeration** with high humidity coated fin coil evaporator.

- Holds 33° F to 41° F for refrigerator

2.5" thick, foamed-in-place polyurethane high density insulation.

#### Stainless steel countertop.

Adjustable bullet feet for extra height requirements (if necessary).

Powdered coated matte black exterior for extra durability against the elements.

#### Door locks standard.

2 epoxy-coated wire shelves per door.

### OPTIONS

- Extra Interior Shelves Qty. \_\_\_\_\_
- Glass Doors- Specify Location \_\_\_\_\_
- Casters Qty. \_\_\_\_\_
- Other Specify \_\_\_\_\_

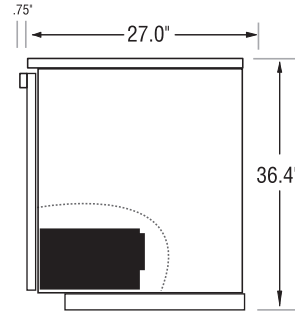

SIDE VIEW

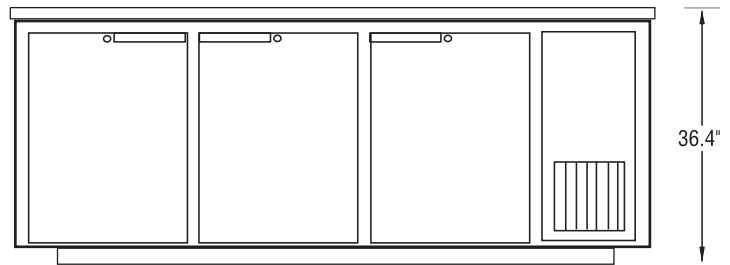

FRONT VIEW

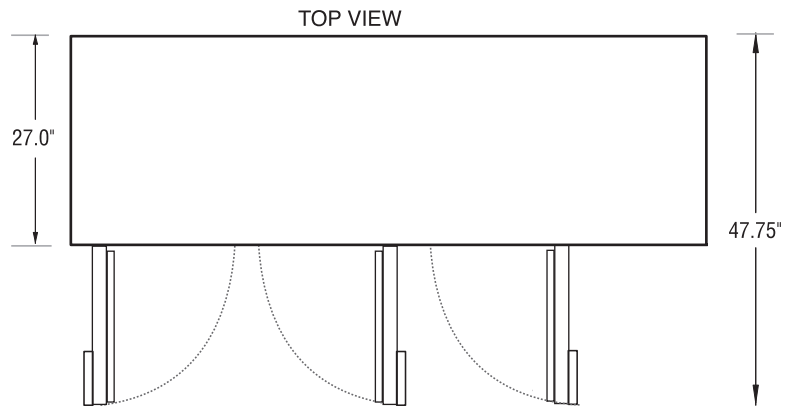

TOP VIEW

### General Information

**Cubic Ft.:** 21

**#Shelves:** 6

**Exterior:** Powdered Coated Steel

**Unit Weight:** 320 lbs

**Interior:** Powder Coated Steel, Stainless Steel bottom

**Ship Weight:** 370 lbs.

### Technical Data

**Refrigerant:** R-134a

**Volts:** 115

**Start Amps:** 7.7

**#Compressors:** 1

**Run Amps:** 6.1

**Cord Length:** 76.0 in.

**Horsepower:** 1/4

SPECIFICATIONS SUBJECT TO CHANGE WITHOUT NOTICE