



THE NEW SYMBOL OF INNOVATION

Two Door Back Bar Cooler



JBB-58 58" wide, 133 (6-packs) or 2 (1/2 barrel kegs)

- **Stainless steel interior bottom standard!**
- **Door locks standard!**
- **Stainless steel countertop standard!**
- **Optional glass doors available.**

STANDARD FEATURES:

- Capillary tube
- CFC-free R-134a Refrigerant
- Forced Air Refrigeration
- One Interior Incandescent Light
- Adjustable Bullet Feet (if necessary)
- Foamed-in-place Polyurethane Insulation
- Thermostatic Control
- Assembled in the USA
- Side-Mounted Compressor
- 2 Epoxy Coated Shelves per door
- Door Locks

MATERIALS:

INTERIOR: Stainless steel interior bottom for durability and appearance.
Galvanized powder coated steel walls.

EXTERIOR: Stainless steel countertop
Galvanized powder coated matte black finish



This equipment is intended for the storage and display of nonpotentially hazardous, bottled or canned products only

DIMENSIONAL DATA:

Model No.	L	D	H	Doors	Cu.Ft.	H/P	Volt	Amp.	NEMA	Shipping Wt.
JBB-58	58.0	27.0	36.4	2	15	1/5	115/60/1	5.1	5-20P	290
JBB-80	80.25	27.0	36.4	3	21	1/4	115/60/1	6.1	5-20P	370
JDD-58	58.0	27.0	36.4	2	15	1/5	115/60/1	5.1	5-20P	290
JDD-80	80.25	27.0	36.4	3	21	1/4	115/60/1	6.1	5-20P	370



Refrigeration Equipment Manufacturer

Back Bar Unit

JBB-58

Description: Two door back bar cooler, 15 cu. ft

Features & Benefits

Stainless steel interior bottom for greater durability, construction and appearance.

Self-contained **side-mounted refrigeration** with high humidity coated fin coil evaporator.

- Holds 33° F to 41° F for refrigerator

2.5" thick, foamed-in-place polyurethane high density insulation.

Stainless steel countertop.

Adjustable bullet feet for extra height requirements (if necessary).

Powdered coated matte black exterior for extra durability against the elements.

Door locks standard.

2 epoxy-coated wire shelves per door.

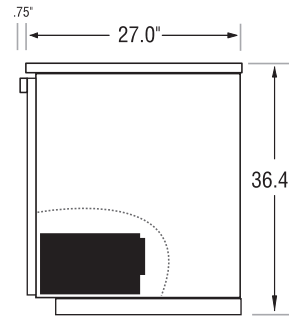

SIDE VIEW

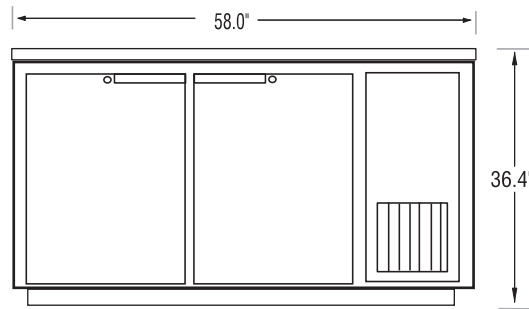

FRONT VIEW

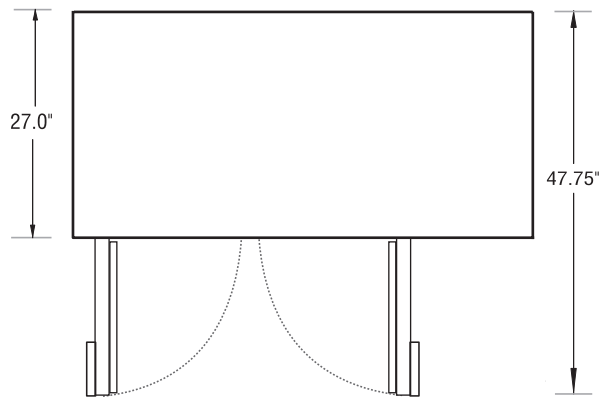

TOP VIEW

OPTIONS

- Extra Interior Shelves Qty. _____
- Glass Doors - Specify Location _____
- Casters Qty. _____
- Other Specify _____

General Information

Cubic Ft.: 15

#Shelves: 4

Exterior: Powdered Coated Steel

Unit Weight: 250 lbs.

Interior: Powder Coated Steel, Stainless Steel bottom

Ship Weight: 290 lbs.

Technical Data

Refrigerant: R-134a

Volts: 115

Start Amps: 5.9

#Compressors: 1

Run Amps: 5.1

Cord Length: 76 in.

Horsepower: 1/5

SPECIFICATIONS SUBJECT TO CHANGE WITHOUT NOTICE